

1

2

3

4

COMPANY PROPRIETY - LEGAL OWNERSHIP

Copyright © Technical Systems. The information contained in this drawing is to be used for official purposes only and shall not be reproduced or transmitted in any form or by any means or disclosed to any third party without prior written permission from Technical Systems. This drawing shall be returned to Technical Systems when no longer contractually required.

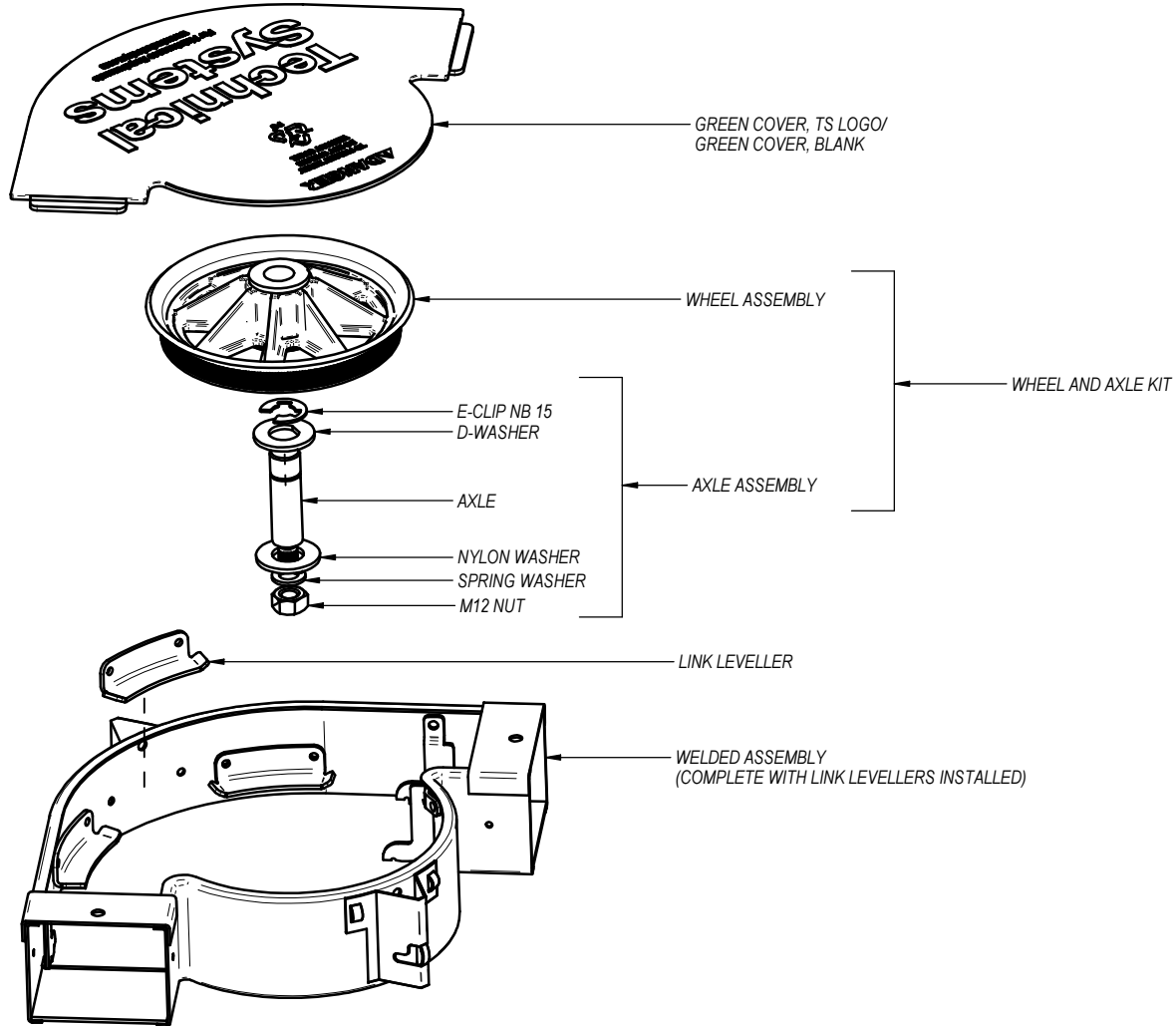

PART DESCRIPTION	QUANTITY	STOCK CODE
WHEEL AND AXLE KIT	1	12424
- WHEEL ASSEMBLY	1	12220
- AXLE ASSEMBLY	1	12221
LINK LEVELLER	1	12234
WELDED ASSEMBLY	1	12218
GREEN COVER, TS LOGO	1	12245
GREEN COVER, BLANK	1	12425

Items indicated in this table are readily available. Should additional parts be required please contact our sales department.

**Technical  
Systems**

MARKET LEADER IN  
FEED CONVEYING  
TECHNICAL SYSTEMS (PTY) LTD  
P.O. BOX 757  
SANLAMHOF 7532  
REPUBLIC OF SOUTH AFRICA

**CU300 REPLACEMENT PARTS**

Document version: 1.2

Date: August 2015